

### Woodfibre insulation wedge for window sills



#### Application areas

For installation under window sills as a secondary weathering protection

- Reliable protection from wind driven rain and snow
- Robust safety for window connections in timber construction
- Ideal for use in combination with STEICOprotect ETICS
- Particular easy to install
- Available in standard lengths and widths
- Compatible with STEICO accessory materials

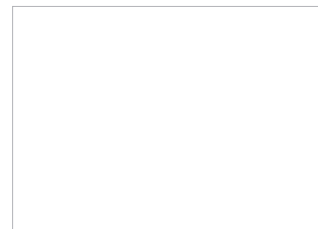
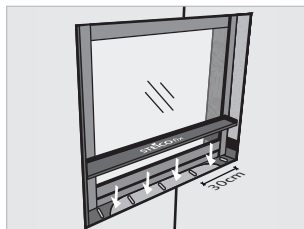
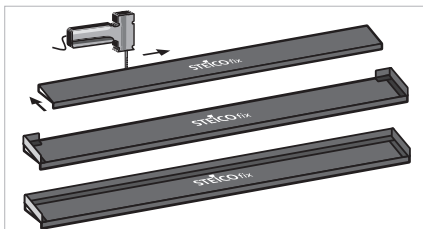

### Delivery formats STEICOfix

Width [mm]	Thickness [mm]	Length [mm]	Pieces/Pack	m/Pack
100	20	1350	25	33.75
140	20	1350	25	33.75
180	20	1350	25	33.75
200	25	1350	25	33.75
260	30	1350	25	33.75

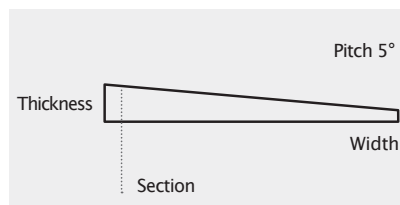

### Technical values STEICOfix

Insulation wedge thickness in [mm]	20 <sup>1)</sup>	25 <sup>1)</sup>	30 <sup>1)</sup>
Length in [mm]	1350		
Pitch	5°		
Fire class according to EN 13501-1	E		
Declared Thermal Conductivity $\lambda$ [W/(m*K)]	0.047		
Water vapour diffusion resistance value $\mu$	7		
Water pressure resistance in [cm] Water column	$\geq 4.000$		
Raw material	woodfibre, polyurethane resin, paraffin, membrane		

**Notes:** STEICOfix should be stored dry and level and protected from UV degradation. STEICOfix can be left exposed externally for up to 4 weeks. Weathering beneath the membrane should be avoided. Connection at joints with STEICOmultipaper with split backing paper 20/40 mm. Hydrophobic woodfibre insulation board with bonded, diffusion open and water resistant membrane.

Quality Management  
ISO 9001:2015

**STEICO**  
engineered by nature

Your STEICO partner



**Sveika statyba**  
Ekostatybinės medžiagos

Taikos pr. 141C, Kaunas, LT-51132 | [www.sveikastatyba.lt](http://www.sveikastatyba.lt) |  
+370 699 96861 | [info@sveikastatyba.lt](mailto:info@sveikastatyba.lt)

[www.steico.com](http://www.steico.com)

